

Interface®

MADE FOR INDUSTRY

**INTERFACE BIOPHARMACEUTICAL
AND LIFE SCIENCES BROCHURE**

NORA® RUBBER | LVT | CARPET TILE | FLOORING EXTRAS



AN INNOVATIVE APPROACH TO FLOORING?



ARCHITECT/DESIGN: CRB GROUP
PHOTO: © RAJ DAS PHOTOGRAPHY

We get it: Your industry is technical. It has to be. And you need flooring to suit the strict demands of your facility.

Interface is a global leader in the engineering and production of high-performance flooring for biopharmaceutical manufacturing facilities. We know a thing or two about flooring — and saving you time and money, too.

- Achieve pharmaceutical elegance with floors that are easy to clean and maintain for a longer aesthetic life
- Create spaces that never need to be resurfaced, that can resist the staining created from harsh chemicals and acids
- Our products and technical support initiatives can help to reduce the risk of flooring failures, resulting in a lower total cost of ownership for you.
- Our integrated system of nora® rubber, LVT, carpet tile, and coordinating accessories provides a range of solutions from simple to challenging spaces.

Our products help you get more from your floor.

That's why we're **Made for More™**.

YOU BET.



EXPLORE OUR SOLUTIONS FOR ANY SPACE

[click here](#)



ARCHITECT/DESIGN: EPPSTEIN UHEN ARCHITECTS
PHOTO: © PETER MCCULLOUGH PHOTO + DRONE

ARCHITECT/DESIGN: BALUNGER
PHOTO: © 2019 HALKIN MASON PHOTOGRAPHY

ARCHITECT/DESIGN: CRB GROUP
PHOTO: © RAJ DAS PHOTOGRAPHY

RELIABILITY?
LOOK NO FURTHER.

Are you looking for flooring that is durable, hygienic, and provides impact resistance? We've got you covered there, too. Interface products are designed to provide an integrated system throughout a biopharmaceutical facility.

What about superior performance, ease of maintenance, and a lower total cost of ownership? nora rubber is resistant to permanent effects from harsh chemicals and disinfectant agents, minimizing downtime.

Interface can even help you to reduce waste with products made to last. And, our reuse and recycling program, ReEntry[®], gives your used carpet tiles and LVT new purpose.

STRICT COMPLIANCE. LOW MAINTENANCE.



PHOTOS: © JACK LEVER



We were able to minimize maintenance costs by using the nora pro clean™ system.”

ANTONIO RUESGA ESTRELLA, OPERATIONS MANAGER, SOPHIA LABORATORIES

| | |
|-----------------------------|-----------------------------------------------------------------------------------------------------------------------------------------------------------------------------------------------------------|
| Location | Jalisco, Mexico |
| Facility Type | Laboratory |
| Challenge | Identify a floor covering that complies with the strict requirements of a pharmaceutical facility, including resistance to microorganism activity, durability, ease of maintenance, and stain resistance. |
| Project Requirements | Durability, low maintenance, stain resistance flooring |
| Product | norament® grano™ noraplan® sheet product |
| Architect/ Design | Taller de Arquitectos 2020/Grupo Alco S.A. de C.V. ARQUITECTOS |



BROWSE
IMAGES AND
LEARN MORE

click here

NO SIGNS OF WEAR



PHOTOS: © JACK LEVER



The nora flooring best suited our needs.”

PROJECT MANAGER

| | |
|-----------------------------|---------------------------------------------------------------------------------------------------------------------------------------------------------------------------------------------------------------------------------------------|
| Facility Type | Biopharmaceutical Manufacturing Facility |
| Challenge | Maintain high levels of cleanliness and appearance that stand up to harsh disinfectants by installing a resilient floor that is resistant to chipping and staining, and with low-maintenance benefits to avoid costly production shutdowns. |
| Project Requirements | Stain resistance, durability, ease of installation and maintenance |
| Product | norament® grano™ |



BROWSE
IMAGES AND
LEARN MORE

click here

YOUR DESIGN PARTNER



TECHNICAL SUPPORT



EASIER DESIGN SOLUTIONS WITH INTERFACE DESIGN STUDIO

Our expert designers know all our product categories inside and out—and their services are complimentary. From concept to completion, they can work closely with you to create distinct designs that meet your vision and budget no matter how large or small the project. To-scale floor plan layouts can project overall waste and act as an installation guide for the flooring contractor. Every floor design includes an embodied carbon calculation, making it easier to design with carbon footprint in mind. Contact your sales rep to get started.



FIND YOUR SALES REP TO START

[click here](#)

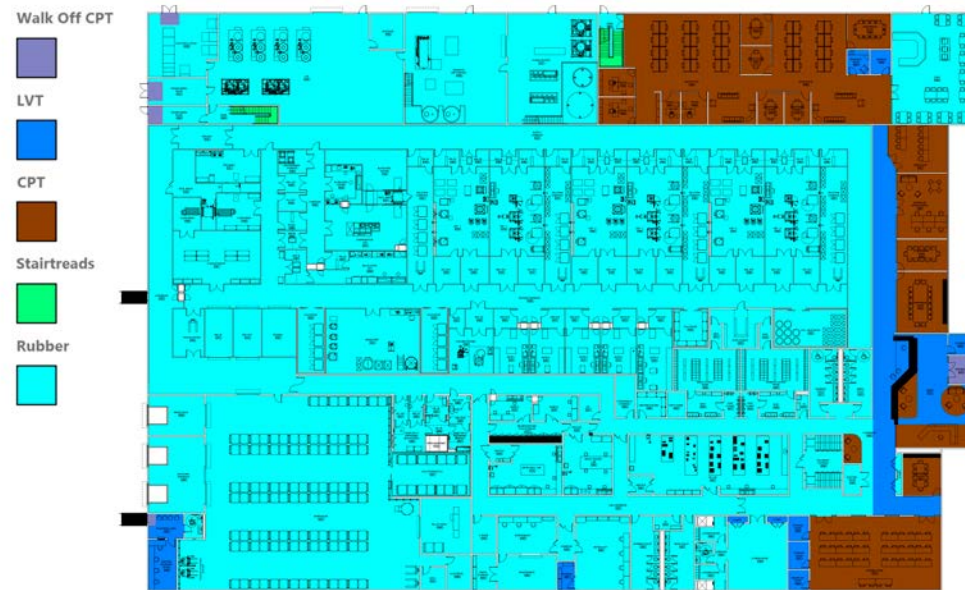

AT YOUR SERVICE - EVERY STEP OF THE WAY

Our experts are available for consultations before, during, and after flooring installation. We can even help develop a comprehensive maintenance plan for a greater return on investment, lower total cost of ownership, and minimal downtime in high-function spaces.

Let us help you make the most of your facility and create spaces that stand up to your most demanding needs.

nora RUBBER

SO DURABLE, IT CAN LAST FOR DECADES—
AND STILL LOOK GOOD.



ARCHITECT/DESIGN: CRB GROUP
PHOTO: © RAJ DAS PHOTOGRAPHY

FROM ENTRYWAYS TO CLEANROOMS AND MORE

COMPLETE YOUR PERFECT FLOORPLAN WITH A
COMPREHENSIVE SELECTION OF FLOORING EXTRAS.



- Industrial flooring that meets strict requirements for sterile and high-function spaces
- Provides chemical and stain resistance. STERIS Tested.
- Reduces incidence of slips, trips, and falls
- Ease of maintenance and reparability with little to no downtime
- Withstands continuous disinfection methods without impacting performance qualities
- Maintains liquid-tight seams and hygienic connections
- Impact sound reduction properties help reduce unwanted noise



PHOTO: © VINCENT UETTILLER

Walk-off carpet

Make the most of your entryways with styles that grab dirt and debris before it can be tracked inside.

interface.com/steprepeat

nora stairwell solutions

All-in-one norament® stairtreads install quickly and withstand heavy traffic—or pair your favorite nora flooring with a nora stair nosing.

nora.com/stairtreads

nora accessories

A range of wall base, welds, and installation options add finishing details and ensure your installation is a success.

nora.com/flooringaccessories

LUXURY VINYL TILE

BRING YOUR VISION TO LIFE WITH TWO DURABLE LVT OPTIONS—3.0 MM LVT OR 4.5 MM SOUND CHOICE™ LVT.



LEARN MORE



click here

CARPET TILE

EVERYTHING YOU LOVE ABOUT SOFT FLOORING BUT WITH THE FLEXIBILITY OF TILE.



LEARN MORE



click here



4.5 mm Sound Choice

- Greater impact sound reduction of IIC 64
- GreenCircle certified 100% recyclable through ReEntry™
- Ceramor™ coating resists slips, scuffs, and scratches
- 39% pre-consumer recycled content

3.0 mm

- Impact sound reduction of IIC 56
- Ceramor™ coating resists slips, scuffs, and scratches
- 39% pre-consumer recycled content



- Ease of installation and replacement with our glue-free TacTiles™ installation system
- Dense construction with premium recycled content nylon fiber
- Solution-dyed fibers to withstand harsh substances
- Intersept™, our proprietary preservative, is permanently incorporated into the backing to protect carpet tiles against mold growth and odor—even at the seams
- Interface's i2™ styles have mergeable dye lots that facilitate selective replacement

WE'RE

'all in'

ON SOLVING
THE CLIMATE
CRISIS

INTERFACE IS COMMITTED TO CREATING HEALTHIER ENVIRONMENTS FOR BIOPHARMACEUTICAL FACILITIES WHILE MEETING THE URGENCY OF THE CLIMATE CRISIS.



Carbon negative carpet tile, which launched in 2020, changed everything for Interface. We now know it's possible to store more carbon than we emit.

So we are challenging ourselves and others to become carbon negative, enterprise wide, without offsets. We've set an incredibly bold and ambitious goal to be carbon negative by 2040, with science based targets set as a 2030 stepping stone on our path.

But our plan is simple. We will continue to avoid, reduce and store as much carbon as we can. And we will inspire others so that we can create a ripple effect for an even bigger positive impact.



*let's plan for a better
world, together*

LEARN HOW
WE'RE 'ALL IN'



click here

nora®, norament®, and noraplan® are trademarks owned by nora systems GmbH and registered in the United States, Canada, and other countries. Other labels used here are trademarks of their respective owners.

Cover Image: Architect/Design: Ballinger, Photo: ©2019 Halkin Mason Photography

interface.com

United States Headquarters

1280 West Peachtree Street NW
Atlanta, GA 30309
1.800.634.6032

Canadian Headquarters

233 Lahr Drive
Belleville, ON K8N 5S2
1.800.267.2149 ext.52128

CIM# IFS00978 03/2025